

Metric Covers and End Plates

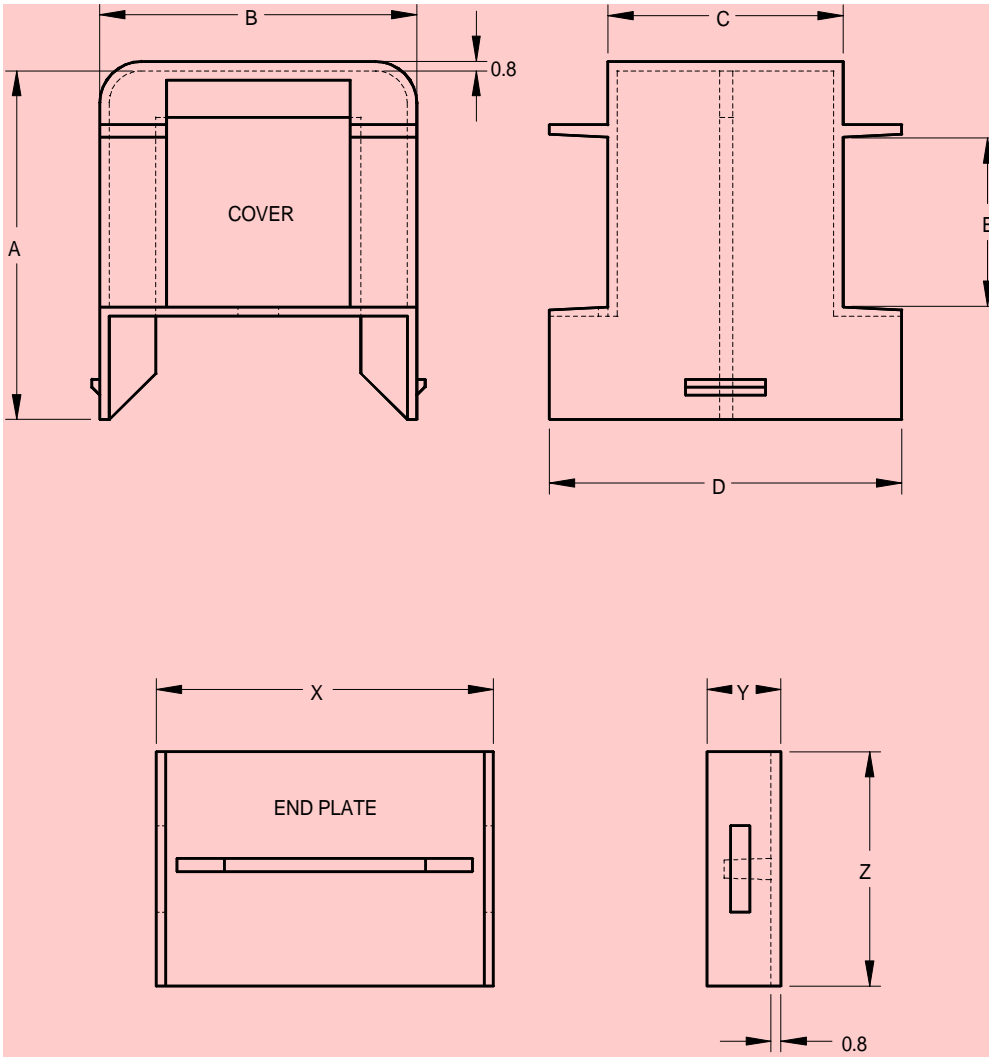

Cover Reference	A	B	C	D	E	Cover Code	
	mm	mm	mm	mm	mm	Nylon 66 UL94HB	Nylon 66 UL94V0
MEI 38 x 7.5	21.80	25.20	18.70	28.00	7.50	M38075CVG	M38075CVF
MEI 38 x 13.6	27.90	25.20	18.70	28.00	13.60	M38136CVG	M38136CVF
MEI 38 x 20.0	34.30	25.20	18.70	28.00	20.00	M38200CVG	M38200CVF
MEI 42 x 14.8	29.80	27.60	20.60	28.50	14.80	M42148CVG	M42148CVF
MEI 48 x 16.8	32.70	31.60	23.70	31.00	16.80	M48168CVG	M48168CVF
MEI 48 x 20.8	36.70	31.60	23.70	31.00	20.80	M48208CVG	M48208CVF
MEI 54 x 18.8	37.00	35.60	26.70	36.10	18.80	M54188CVG	M54188CVF
MEI 54 x 25.5	43.70	35.60	26.70	36.10	25.50	M54255CVG	M54255CVF

End Plate Reference	X	Y	Z	End Plate Code	
	mm	mm	mm	Nylon 66 UL94HB	Nylon 66 UL94V0
MEI 38	26.80	5.90	18.70	M38000EPG	M38000EPF
MEI 42	32.40	5.90	20.60	M42000EPG	M42000EPF
MEI 48	33.20	5.90	23.70	M48000EPG	M48000EPF
MEI 54	37.30	5.90	26.70	M54000EPG	M54000EPF

FORMERS